

2

1

## PARTS LIST

ITEM	PART #	DESCRIPTION	NOTES
1	K2015/4075	Medium Body w/ 6in Radius Corners	Assembly
2	K2086/95/4255	Tension Frame II & Bleed Cover w/ 6in Radius Corners & Covers	Assembly
10	5170	Hinge Screw	Drill 3/8" pilot hole
11	5180	Closure Screw	Drill 5/16" pilot hole

**NOTE: PRE-CUT KITS ARE NOT PRE-DRILLED.**

(Holes shown in this drawing are for reference only.  
Drilling of pilot holes are to be done by fabricator.)

Ship To:  
Sales Order #

**\*NOTE:** Drill a 3/8"  
oversized hole for  
the head of the  
hinge screw to  
slip through.

DETAIL A  
HINGED

**\*NOTE:** IT IS RECOMMENDED THAT THE FRAME  
BE ASSEMBLED ON THE BODY, THEN RATCHET  
STRAPPED TO CHECK FOR SQUARE, BEFORE  
THE FRAME IS WELDED OR MECHANICALLY  
FASTENED.

DETAIL B  
FRAME CLOSED

DETAIL B  
CROSS-SECTION

TOP CROSS-SECTION

Drive the hinge screw down into the  
body so the head of the screw is  
under the retainer flange as shown.

THIS DRAWING WAS CREATED AT NO CHARGE TO ASSIST YOU IN VISUALIZING OUR PROPOSAL. THE DRAWING HEREIN IS THE PROPERTY OF SIGNCOMP. PERMISSION TO COPY OR REVISE THIS DRAWING OR TO USE THIS DRAWING FOR PRODUCTION IS STRICTLY PROHIBITED AND CAN ONLY BE COPIED, REVISED OR USED FOR PRODUCTION WITH THE EXPRESSED WRITTEN PERMISSION OF SIGNCOMP.

Project Name: Medium Body w/ Tension Frame II & Bleed Cvr - 6" Rad. Corners  
Sign Company: KMB/86/95/4558  
Part #:   
Revision:   
Date: 5/15/2019  
Drawing By: SBreihof  
Sheet: 1 of 1  
Size: A

**SignComp**

B

B

A

A

2

1

PARTS LIST			
ITEM	PART#	DESCRIPTION	NOTES
1	2015	Medium Body	Top & Bottom
2	2015	Medium Body	Sides
3	4075	Medium Body 6in Radius Corner	
65	5218	Radius Corner Screw	Drill 5/32" pilot hole

Ship To:  
Sales Order#

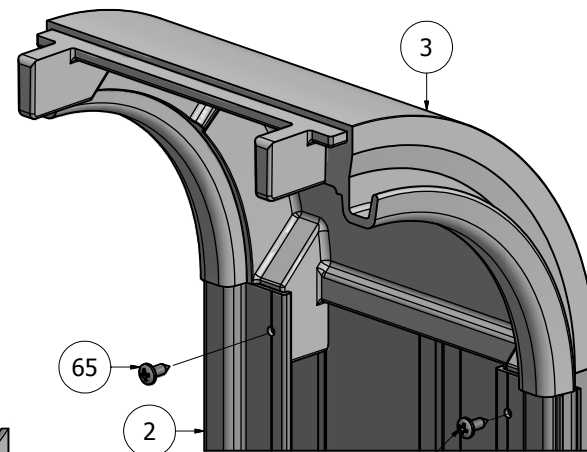
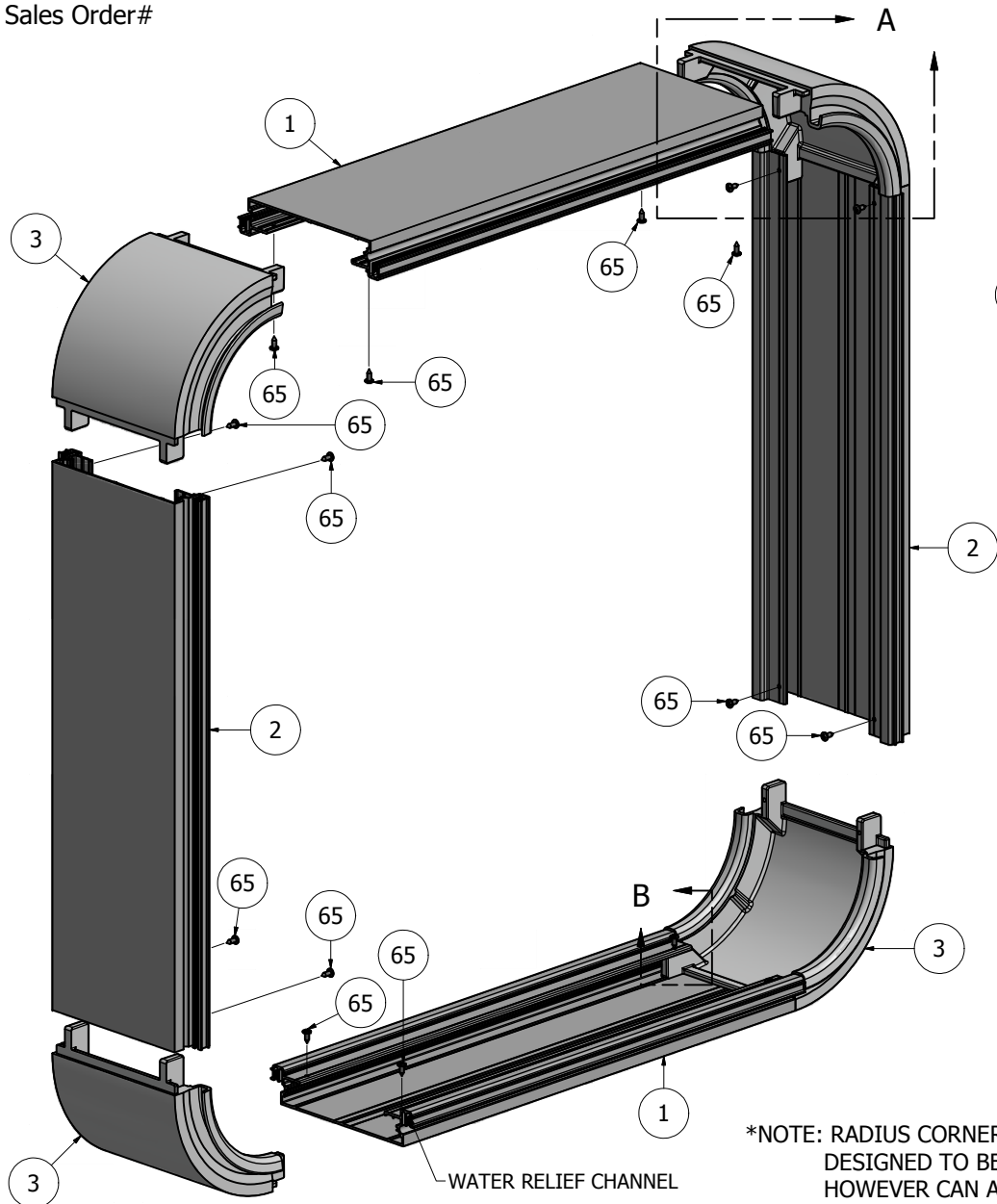

DETAIL A

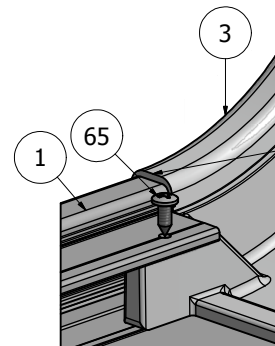

DETAIL B

Caulk the joints where the Radius Diecast Corners and the Extrusion meet, yet making sure the water relief channel is not blocked, allowing the water to flow.

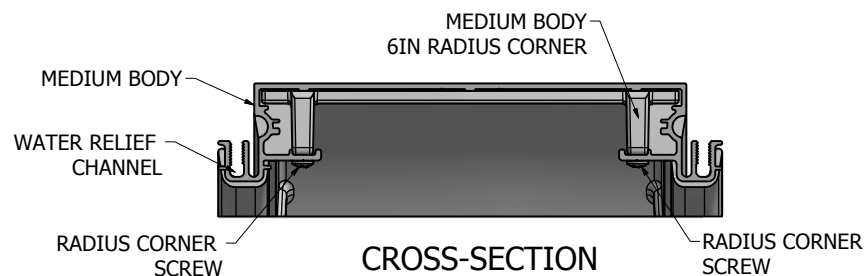

CROSS-SECTION

**NOTE: PRE-CUT KITS ARE NOT PRE-DRILLED.**

(Holes shown in this drawing are for reference only. Drilling of pilot holes are to be done by fabricator.)

\*NOTE: RADIUS CORNERS ARE DESIGNED TO BE WELDED, HOWEVER CAN ALSO BE MECHANICALLY ASSEMBLED.

THIS DRAWING WAS CREATED AT NO CHARGE TO ASSIST YOU IN VISUALIZING OUR PROPOSAL. THE DRAWING HEREIN IS THE PROPERTY OF SIGNCOMP. PERMISSION TO COPY OR REVISE THIS DRAWING OR TO USE THIS DRAWING FOR PRODUCTION IS STRICTLY PROHIBITED AND CAN ONLY BE COPIED, REVISED OR USED FOR PRODUCTION WITH THE EXPRESSED WRITTEN PERMISSION OF SIGNCOMP.

DRAWN	SBreihof	10/23/2012	<b>SignComp</b>
Centroid X:	0.000 in	TITLE	
Centroid Y:	0.000 in	Medium Body w/ 6in Radius Corners - Assembly	REV
Principal Moments Ix:	0.000 in <sup>4</sup>	DWG NO	
Principal Moments Iy:	0.000 in <sup>4</sup>	<b>KMB-4075</b>	
Section Modulus Ix:	0.000 in <sup>3</sup>		
Section Modulus Iy:	0.000 in <sup>3</sup>		

PARTS LIST			
ITEM	PART #	DESCRIPTION	NOTES
1	2086	Tension Frame II	Top & Bottom
2	2086	Tension Frame II	Sides
3	4255	6in Tension Frame II Radius Corner	All 4 Corners
65	5218	Radius Corner Screw	Drill 5/32" pilot hole

**NOTE: PRE-CUT KITS ARE NOT PRE-DRILLED.**

(Holes shown in this drawing are for reference only.  
Drilling of pilot holes are to be done by fabricator.)

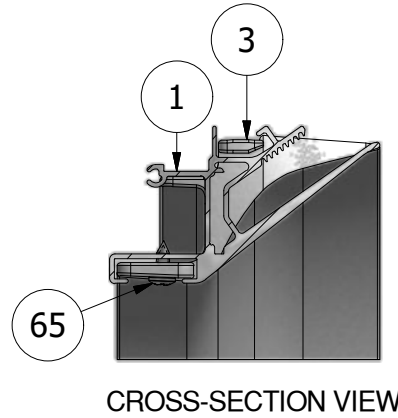
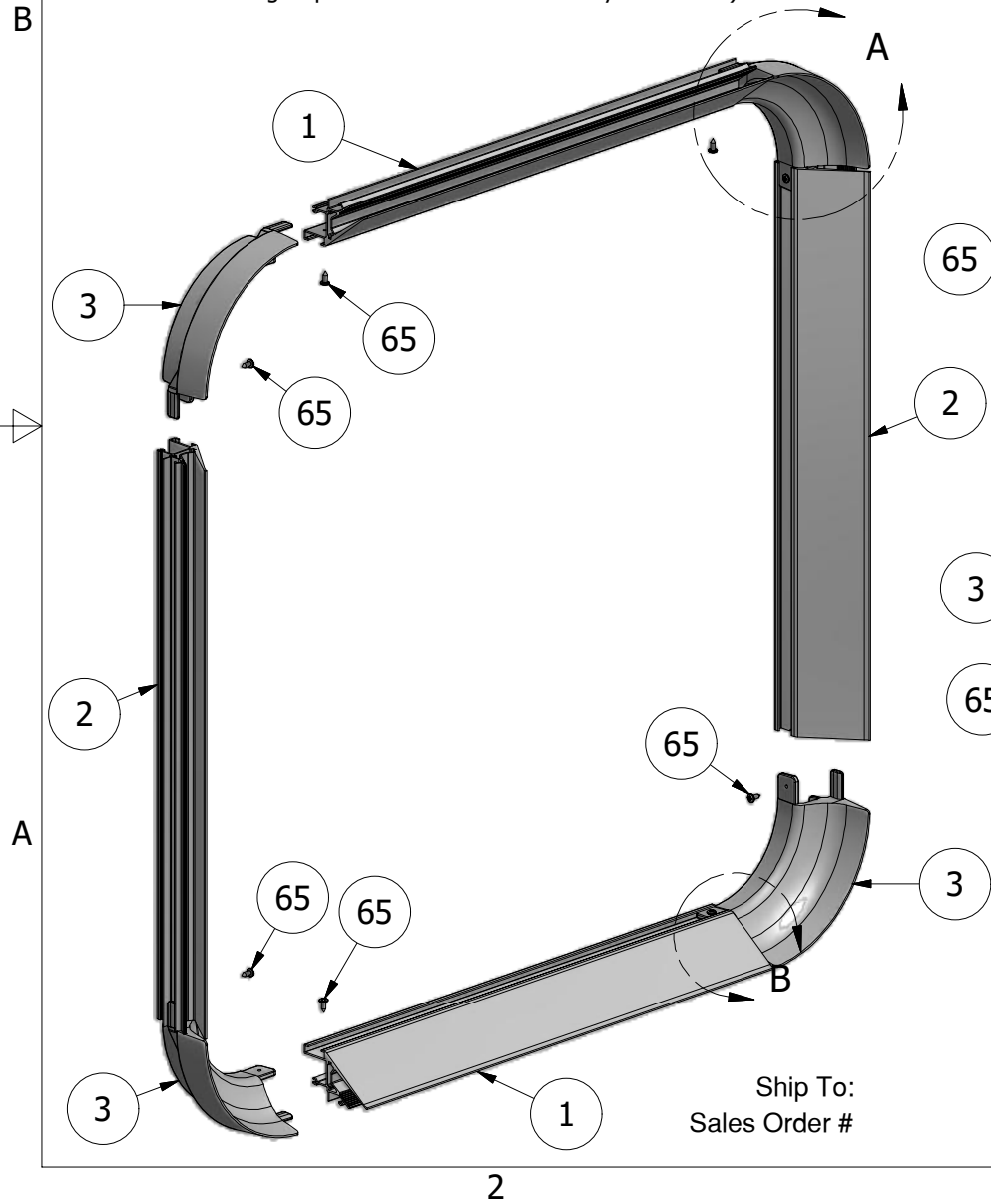

**\*NOTE: GAPS ARE REQUIRED FOR PROPER ASSEMBLY.**

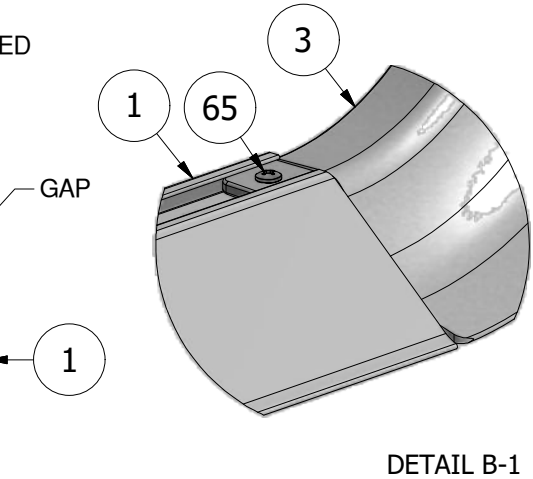
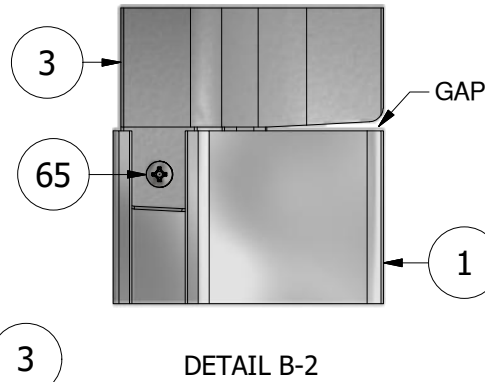

**\*NOTE: IT IS RECOMMENDED THAT THE FRAME BE ASSEMBLED ON THE BODY, THEN RATCHET STRAPPED TO CHECK FOR SQUARE, BEFORE THE FRAME IS WELDED OR MECHANICALLY FASTENED.**

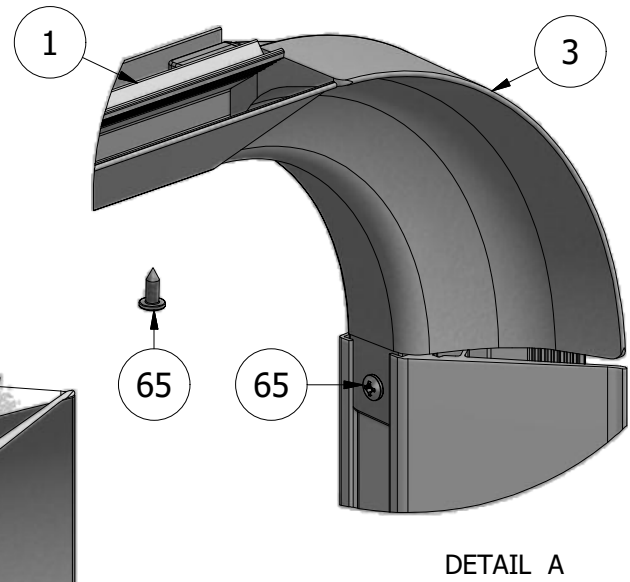

THIS DRAWING WAS CREATED AT NO CHARGE TO ASSIST YOU IN VISUALIZING OUR PROPOSAL. THE DRAWING HEREIN IS THE PROPERTY OF SIGNCOMP. PERMISSION TO COPY OR REVISE THIS DRAWING OR TO USE THIS DRAWING FOR PRODUCTION IS STRICTLY PROHIBITED AND CAN ONLY BE COPIED, REVISED OR USED FOR PRODUCTION WITH THE EXPRESSED WRITTEN PERMISSION OF SIGNCOMP.

Project Name: Tension Frame II with 6" Rad. Corners - Assembly

Sign Company: K2086-4255

Part #:

Revision:

Date: 5/14/2019

Drawing By: SBreihof

Sheet: 1 of 1

Size:

A

**SignComp**

A

B

## PARTS LIST

ITEM	PART #	DESCRIPTION	NOTES
1	K2086/4255	Tension Frame II w/ 6in Radius Corners	Assembly
2	2095	Bleed Tension Frame Cover	Top & Bottom
3	2095	Bleed Tension Frame Cover	Sides
4	4265P	6in Bleed Tension Frame Radius Cover	
12	5195	Cover Screw	Pre-drill 3/32" hole
15	5195	Radius Corner Cover Screw	Pre-drill 3/32" hole

Ship To:  
Sales Order #

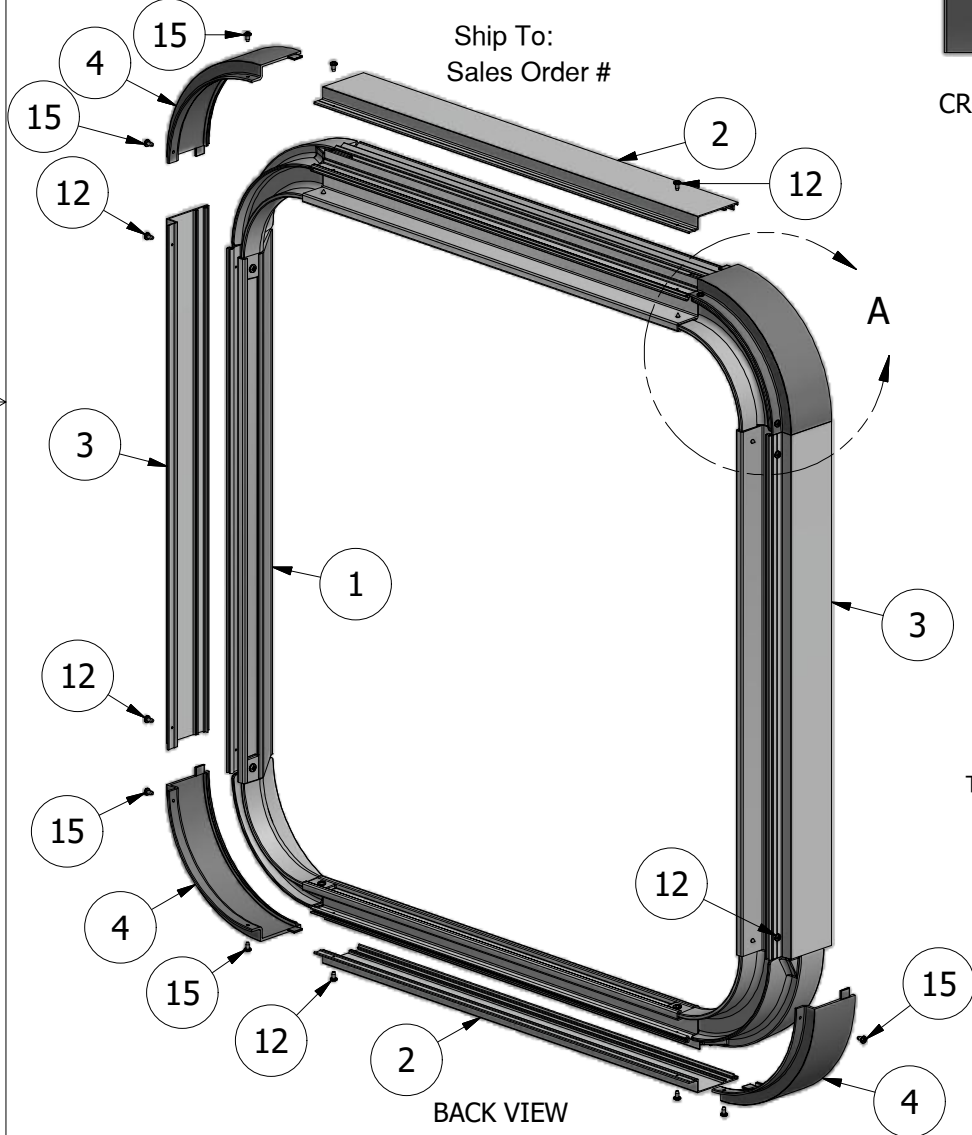

BACK VIEW

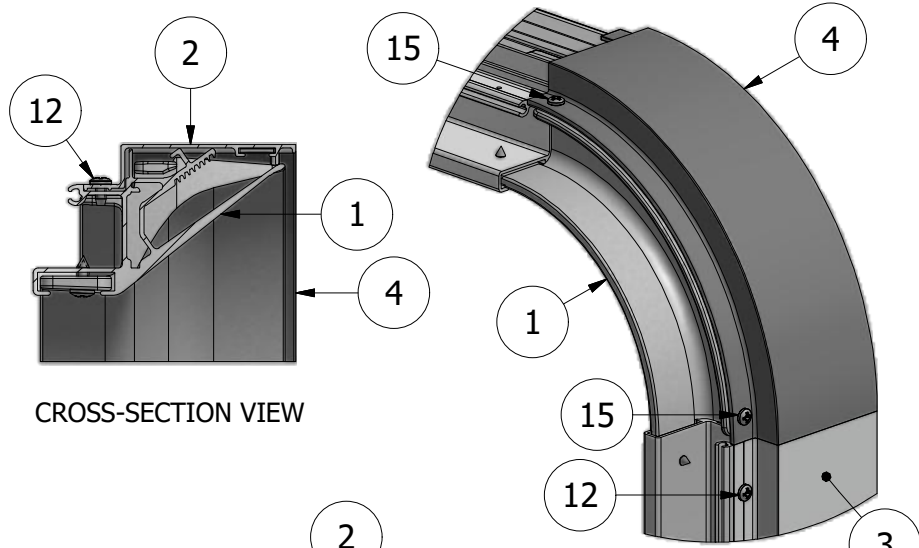

CROSS-SECTION VIEW

DETAIL A-1

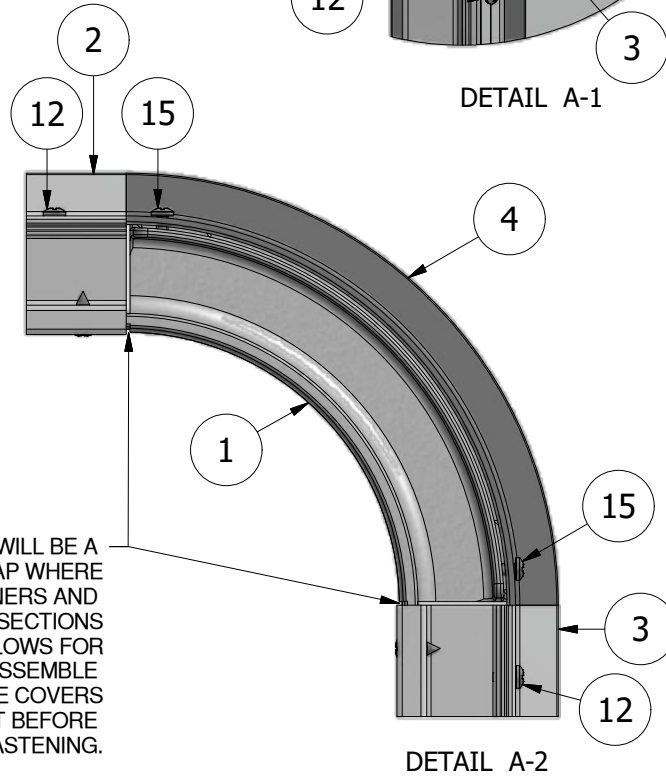

DETAIL A-2

**\*NOTE:** THERE WILL BE A CONSISTANT GAP WHERE THE RADIUS CORNERS AND TENSION FRAME SECTIONS MEET. THIS ALLOWS FOR THE FRAME TO ASSEMBLE SQUARE AND THE COVERS TO FIT TIGHT BEFORE FASTENING.

**NOTE: PRE-CUT KITS ARE NOT PRE-DRILLED.**  
(Holes shown in this drawing are for reference only. Drilling of pilot holes are to be done by fabricator.)

THIS DRAWING WAS CREATED AT NO CHARGE TO ASSIST YOU IN VISUALIZING OUR PROPOSAL. THE DRAWING HEREIN IS THE PROPERTY OF SIGNCOMP. PERMISSION TO COPY OR REVISE THIS DRAWING OR TO USE THIS DRAWING FOR PRODUCTION IS STRICTLY PROHIBITED AND CAN ONLY BE COPIED, REVISED OR USED FOR PRODUCTION WITH THE EXPRESSED WRITTEN PERMISSION OF SIGNCOMP.

<b>SignComp</b>	Project Name: Tension Frame II and Bleed Cover - 6" Rad. Covers - Assembly
	Part #: K2086-95-4265P
Size: A	Drawing By: SBreihof
Sheet: 1 of 1	Date: 5/14/2019
Revision:	Revision:

ITEM	PART #	DESCRIPTION
1	2015	Medium Body
2		MB Support Mounting Plate - By Other
3		Main Support Plate Bolt Assembly
4		Main Support
5	5116	Raceway Cover - Blank
6		Lamp & Socket
7	2086	Tension Frame II
8	5210	Corner Key
9	5305	Frame Corner Angle
10	5352	Small Frame Brace
11	2095	Bleed Tension Frame Cover
12	2177	Small Frame Support Tube - 1"

**NOTE: PRE-CUT KITS ARE NOT PRE-DRILLED.**  
 (Holes shown in this drawing are for reference only.  
 Drilling of pilot holes are to be done by fabricator.)

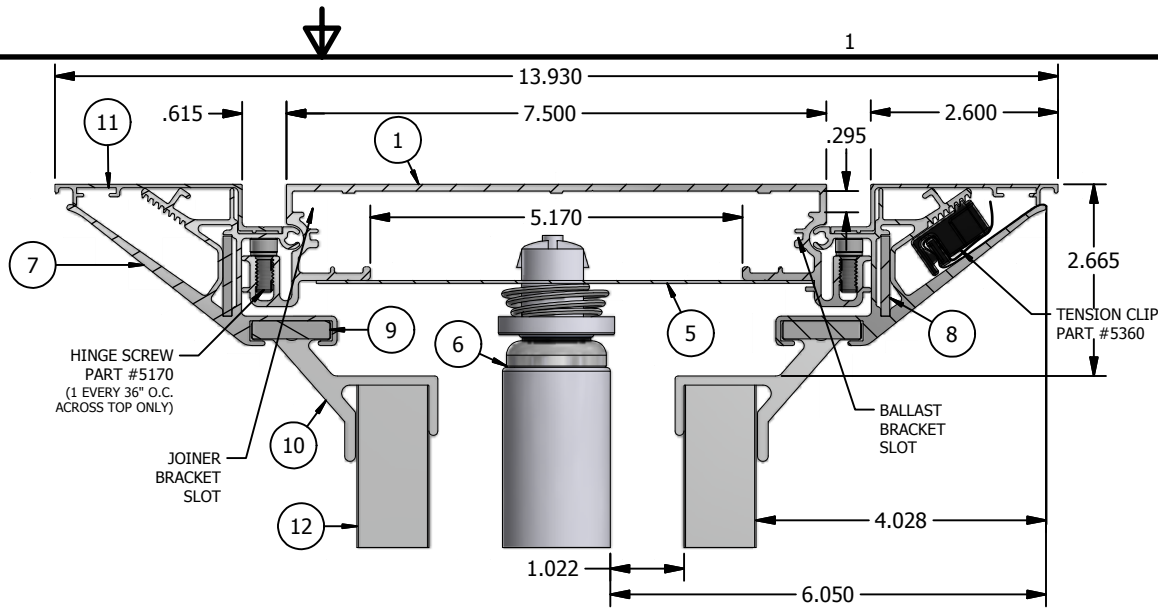

SECTION VIEW - ELECTRICAL

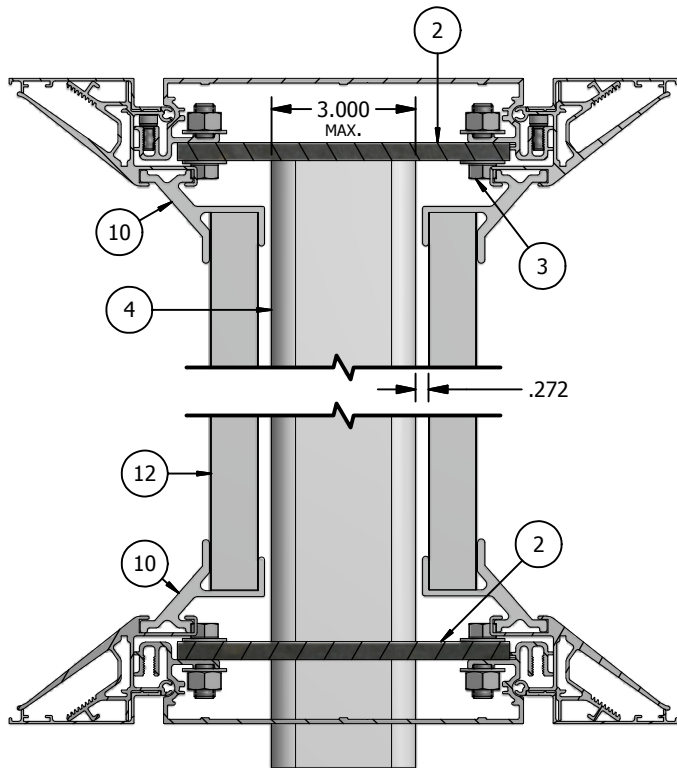

SECTION VIEW - STRUCTURAL

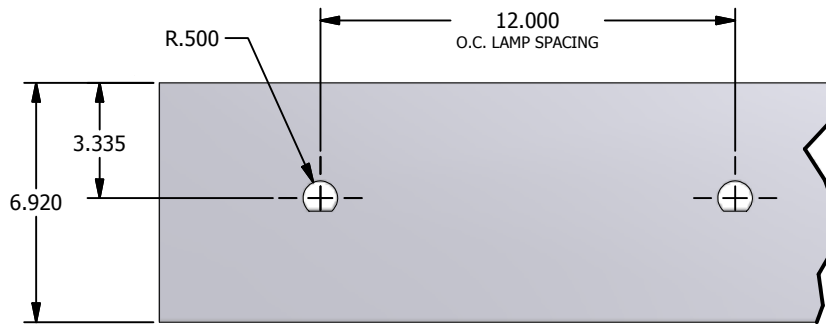

RACEWAY D-PUNCH DETAIL

**NOTES:**

1. ADD 1" TO SIZE OF CABINET (VERTICAL OR HORIZONTAL) WHEN THE SIZE OF THE CABINET IS THE SAME SIZE AS THE NOMINAL LAMP LENGTH.
2. SIGNCOMP DOES NOT SUPPLY THE BALLAST(S), LAMPS OR LAMP SOCKETS.
3. SIGNCOMP DOES NOT SUPPLY MAIN SUPPORT.

**NOTE:**

All structural detailing for sign construction is the sole responsibility of the sign contractor. All details shown here should be considered as **DESIGN INTENT ONLY**. The sign fabricator shall provide engineering drawings stamped by a licenced structural engineer.

THIS DRAWING WAS CREATED AT NO CHARGE TO ASSIST YOU IN VISUALIZING OUR PROPOSAL. THE DRAWING HEREIN IS THE PROPERTY OF SIGNCOMP. PERMISSION TO COPY OR REVISE THIS DRAWING OR TO USE THIS DRAWING FOR PRODUCTION IS STRICTLY PROHIBITED AND CAN ONLY BE COPIED, REVISED OR USED FOR PRODUCTION WITH THE EXPRESSED WRITTEN PERMISSION OF SIGNCOMP.

Project Name:	MB w/ Tension Frame II & Cover - Cross Sect.
Sign Company:	SignComp
Revision:	9/15/2014
Drawing By:	SBreihof
Sheet:	1 of 1
Size:	A

**SignComp**

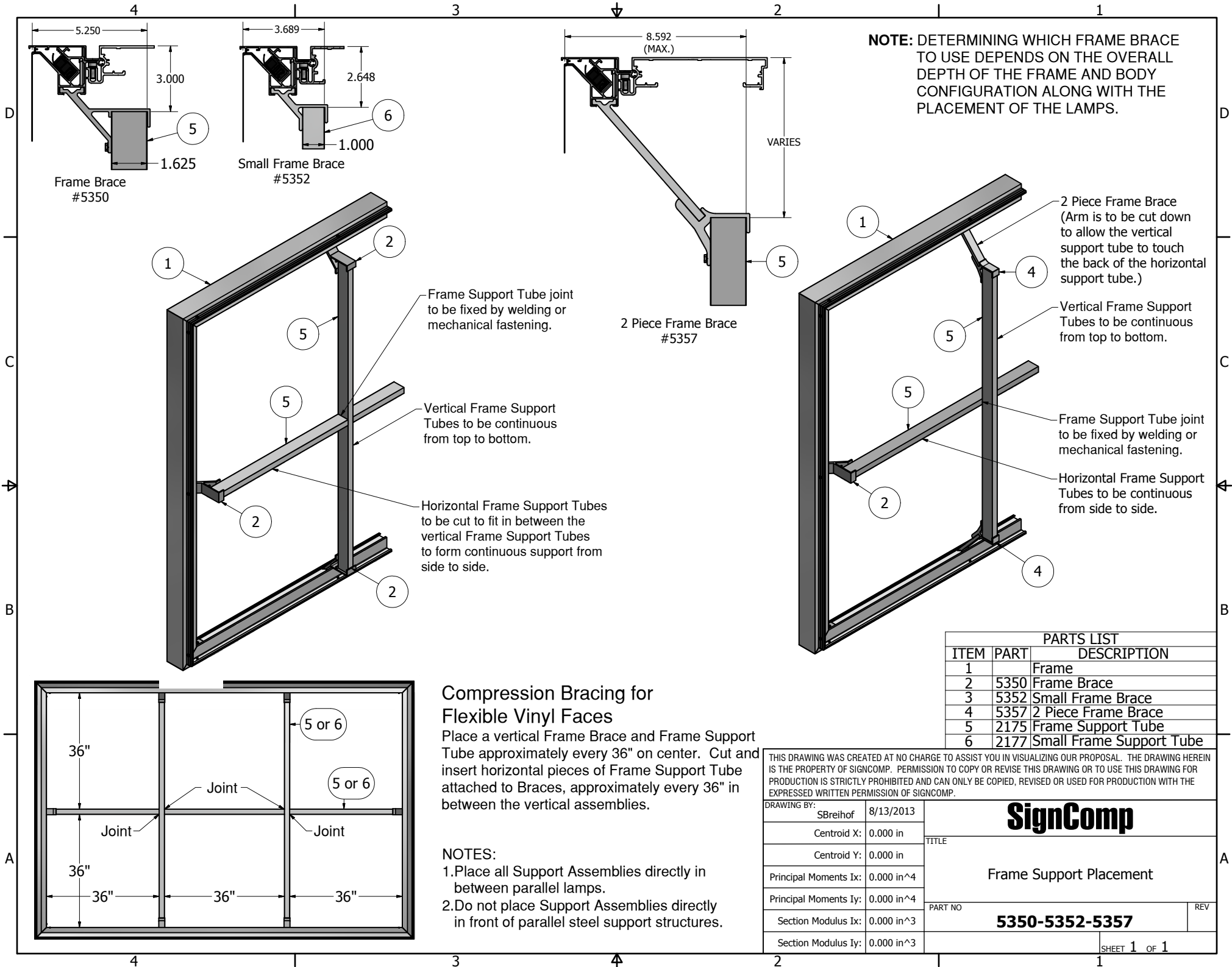

**NOTE:** DETERMINING WHICH FRAME BRACE TO USE DEPENDS ON THE OVERALL DEPTH OF THE FRAME AND BODY CONFIGURATION ALONG WITH THE PLACEMENT OF THE LAMPS.

Frame Support Tube joint to be fixed by welding or mechanical fastening.

Vertical Frame Support Tubes to be continuous from top to bottom.

Horizontal Frame Support Tubes to be cut to fit in between the vertical Frame Support Tubes to form continuous support from side to side.

2 Piece Frame Brace (Arm is to be cut down to allow the vertical support tube to touch the back of the horizontal support tube.)

Vertical Frame Support Tubes to be continuous from top to bottom.

Frame Support Tube joint to be fixed by welding or mechanical fastening.

Horizontal Frame Support Tubes to be continuous from side to side.

PARTS LIST		
ITEM	PART	DESCRIPTION
1		Frame
2	5350	Frame Brace
3	5352	Small Frame Brace
4	5357	2 Piece Frame Brace
5	2175	Frame Support Tube
6	2177	Small Frame Support Tube

### Compression Bracing for Flexible Vinyl Faces

Place a vertical Frame Brace and Frame Support Tube approximately every 36" on center. Cut and insert horizontal pieces of Frame Support Tube attached to Braces, approximately every 36" in between the vertical assemblies.

**NOTES:**

1. Place all Support Assemblies directly in between parallel lamps.
2. Do not place Support Assemblies directly in front of parallel steel support structures.

THIS DRAWING WAS CREATED AT NO CHARGE TO ASSIST YOU IN VISUALIZING OUR PROPOSAL. THE DRAWING HEREIN IS THE PROPERTY OF SIGNCOMP. PERMISSION TO COPY OR REVISE THIS DRAWING OR TO USE THIS DRAWING FOR PRODUCTION IS STRICTLY PROHIBITED AND CAN ONLY BE COPIED, REVISED OR USED FOR PRODUCTION WITH THE EXPRESSED WRITTEN PERMISSION OF SIGNCOMP.

DRAWING BY:	SBreihof	8/13/2013
Centroid X:	0.000 in	
Centroid Y:	0.000 in	
Principal Moments Ix:	0.000 in <sup>4</sup>	
Principal Moments Iy:	0.000 in <sup>4</sup>	
Section Modulus Ix:	0.000 in <sup>3</sup>	
Section Modulus Iy:	0.000 in <sup>3</sup>	

**SignComp**

TITLE  
**Frame Support Placement**

PART NO  
**5350-5352-5357**

REV

SHEET 1 OF 1